

## SEPARATOR SPR 25

### MAIN CHARACTERISTICS

The separator SPR 25 is a piping component used for the removal of water, oil and dusts particles on the steam or compressed air networks of small diameters. It allows to obtain a clean and dry gas and it protects the sensitive devices installed downstream : pressure regulators, control valves, flowmeters,... In the case of the steam, it improves the efficiency on the thermal exchange. The stainless steel type is particularly adapted to the clean steam and clean compressed air networks.

This separator is sized according to the code of calculation AD Merkblatt 2000 and according to pressure equipment directive 97/23.



### AVAILABLE MODELS

Materials : carbon steel or stainless steel

Diameters : 1/2" to 1"

Connecting : BSP thread

### LIMITS OF USE

|                                    |        |
|------------------------------------|--------|
| Max allowed fluid pressure : PS    | 20 bar |
| Max allowed fluid temperature : TS | 250°C  |



### REGULATIONS AND STANDARD OF CONSTRUCTION

| Item                                 | Standard                         | Item                      | Standard   |
|--------------------------------------|----------------------------------|---------------------------|------------|
| Pressure equipment directive 2014/68 | <b>G1/2"</b> : A4§3 excluded     | Material certificate      | EN 10204   |
|                                      | <b>G3/4" - G1"</b> : Catégorie I |                           |            |
| Sizing                               | AD Merkblatt 2000                | Stainless steel materials | EN 10217-7 |
| BSP thread                           | ISO 228                          | Carbon steel materials    | EN 10216-2 |

## SEPARATOR SPR 25

### CONSTRUCTION

| n° | Item                 | Steel material SPR       | Stainless steel material SPR       |
|----|----------------------|--------------------------|------------------------------------|
| 1  | Body                 | Carbon steel             | Stainless steel AISI 304L / 1.4307 |
| 2  | Cover                | Carbon steel             | Stainless steel AISI 304L / 1.4307 |
| 3  | Cylinder bottom      | Carbon steel             | Stainless steel AISI 304L / 1.4307 |
| 4  | Pipe                 | Carbon steel             | Stainless steel AISI 304L / 1.4307 |
| 5  | Pipes input / output | Carbon steel             | Stainless steel AISI 304L / 1.4307 |
| 6  | Particle trap        | Carbon steel             | Stainless steel AISI 304L / 1.4307 |
| 7  | Metal cover          | Carbon steel             | Stainless steel AISI 304L / 1.4307 |
| 8  | Separation plate     | Carbon steel             | Stainless steel AISI 304L / 1.4307 |
| 9  | Protection strainer  | Stainless steel AISI 304 | Stainless steel AISI 304           |
| 10 | Gasket               | Brass                    | Brass                              |
| 11 | Plug                 | Carbon steel C22.8       | Stainless steel 1.4408             |

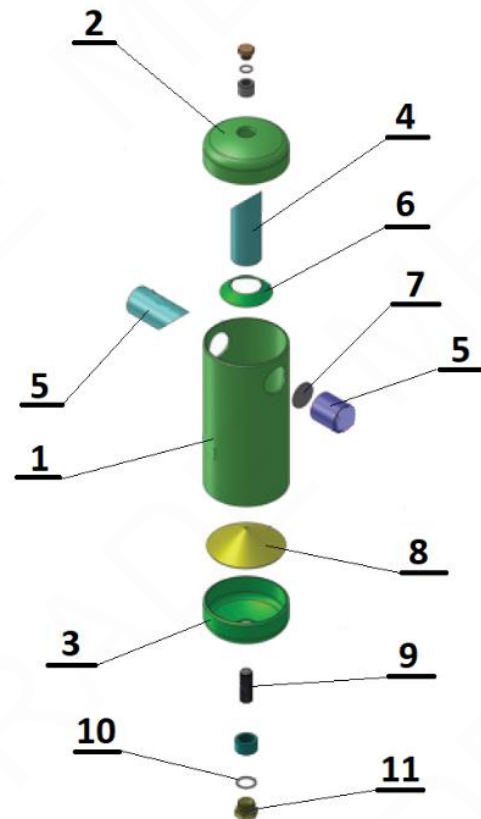
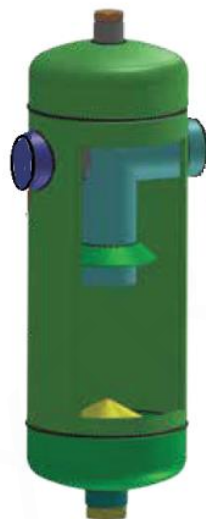

## SEPARATOR SPR 25

### DIMENSIONS (mm) CONNECTIONS AND WEIGHT (kg)

| DN     | Volume (l) | A     | H   | L   | Ø M   | Ø Drain | Ø Vent | Weight (kg) |
|--------|------------|-------|-----|-----|-------|---------|--------|-------------|
| G 1/2" | 1,5        | 250,5 | 356 | 127 | 88.9  | G 1/2"  | G 1/2" | 2.15        |
| G 3/4" | 2,9        | 299   | 411 | 146 | 114.3 | G 1/2"  | G 1/2" | 4           |
| G 1"   | 3,1        | 315   | 427 | 158 | 114.3 | G 1/2"  | G 1/2" | 4.4         |

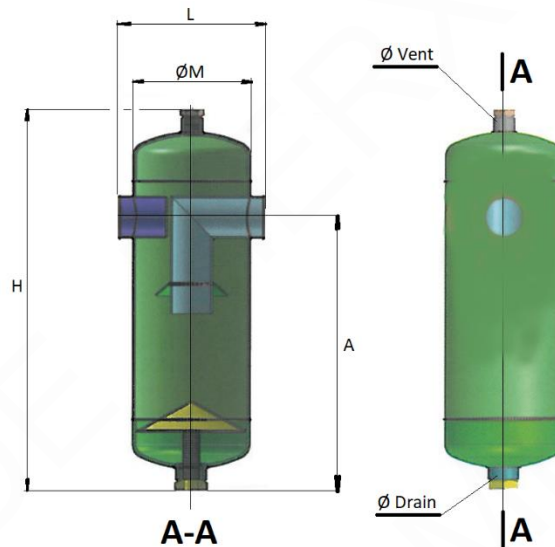

### FLOWRATE AND DIAGRAMM OF PRESSURE LOSS FOR STEAM

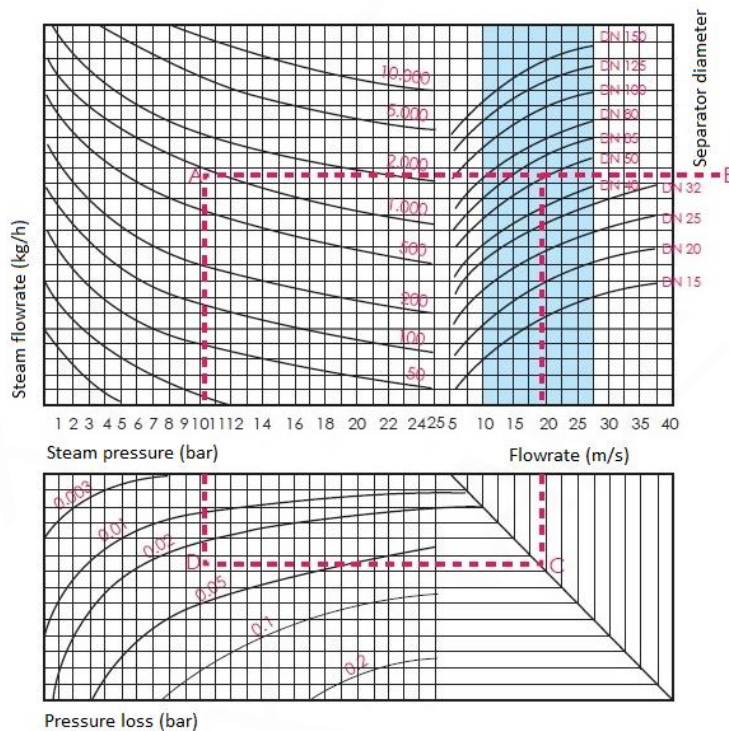

Leave the upper left diagram by locating the point A from the steam flowrate in of the service pressure. Deduct the point from it B on the upper right diagram the diameter of the separator with regard to the chosen speed. Continue on the diagram of bottom the point C and find the point D which indicates the pressure loss of load through the separator.

Modifications reserved

## SEPARATOR SPR 25

### INSTALLATION

The low point must be equipped with a trap (Steam or compressed air).

The high point can be equipped with various accessories (Air eliminator, vacuum breaker, pressure gauge)

It is necessary to plan a support adapted to the weight of the separator.

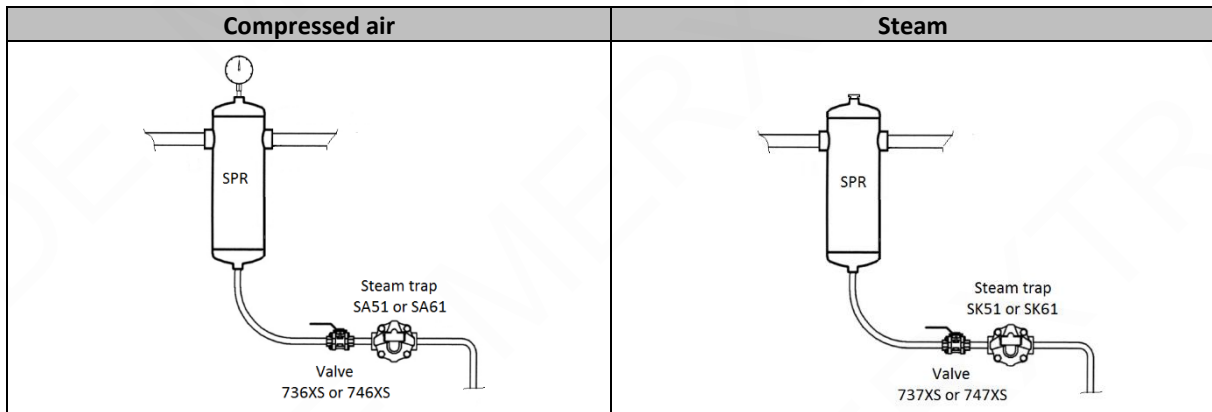

### MAINTENANCE

SPR 25 requires no maintenance.

Pressure tank subject to periodic inspection following the decree of 20 November 2017.